

**p. 44 Project — Speech**  
**Architects: Sergey Tchoban, Sergey Kuznetsov**  
*When new architecture is created, the discovery of a new shape is my top priority*

2012



# PROJECT SPEECH



**Sergey Tchoban**  
architect



**Sergey Kuznetsov**  
architect

The SPEECH Tchoban & Kuznetsov bureau led by Sergey Tchoban and Sergey Kuznetsov was founded in 2006. SPEECH is one of the leading architectural bureaus in Russia. It specializes in designing buildings and complexes for different functional purposes, developing urban planning concepts and also formulating interior decisions.

This collection includes the characteristic traits of purism and free style shape design. The orthogonal configuration and curvilinear details harmoniously complement each other. This collection is characterized by the continuity of its plain wooden surface, forming a basic frame in contrast with the varnished functional elements.

This collection will complement any interior design due to its versatile nature, whereas the quality of materials and surface treatments will satisfy the most demanding tastes.

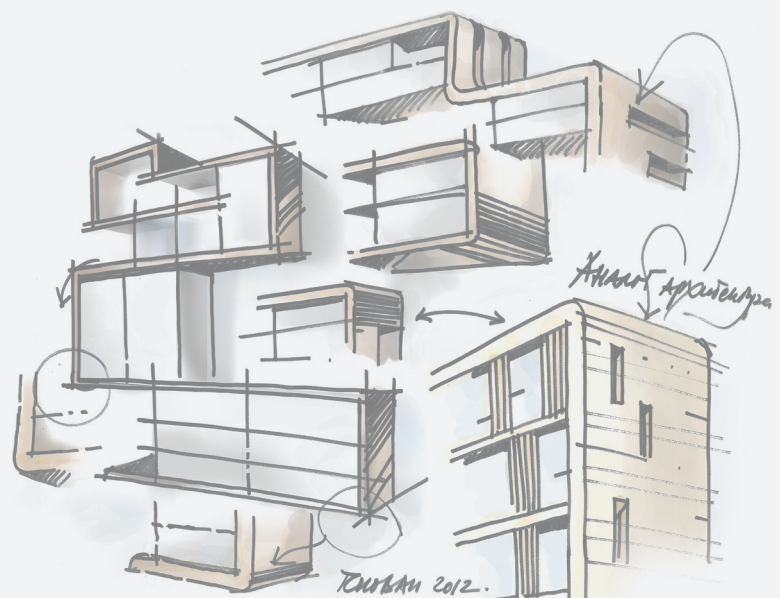
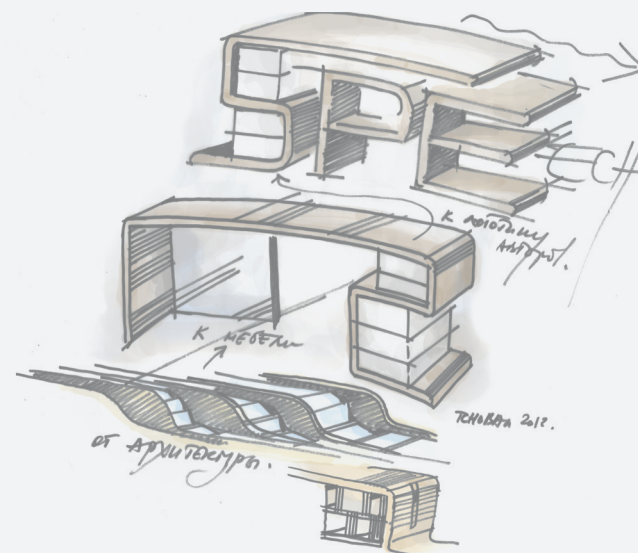

### Sergey Kuznetsov:

«We aim to utilize elastic and smooth lines and shapes in our projects, reminiscent of the plastic figure of the human body. We try to design items that are nice to look at, and pleasant to the touch. Just like any idea going through the stages of development from the first image to the real product, our conception has certainly undergone certain adjustments under the influence of industrial and technological potential. Something became simpler, another thing was significantly changed, and something else had to be rejected. However, this is inevitable. Our main task is to create and then implement one bright concept. I believe that we managed to achieve this goal».

◆ colored lacquer



2014







Sergey Tchoban:

«When new architecture is created, the discovery of a new shape is my top priority. However, this shape must not clash, but rather fit harmoniously into the proposed environment. It must endure not only with respect to the materials, but also with respect to the discovered image. This was a guiding work principle during Project Speech for which we found a soft, smooth and, subsequently, a decisive shape».

◆ colored lacquer



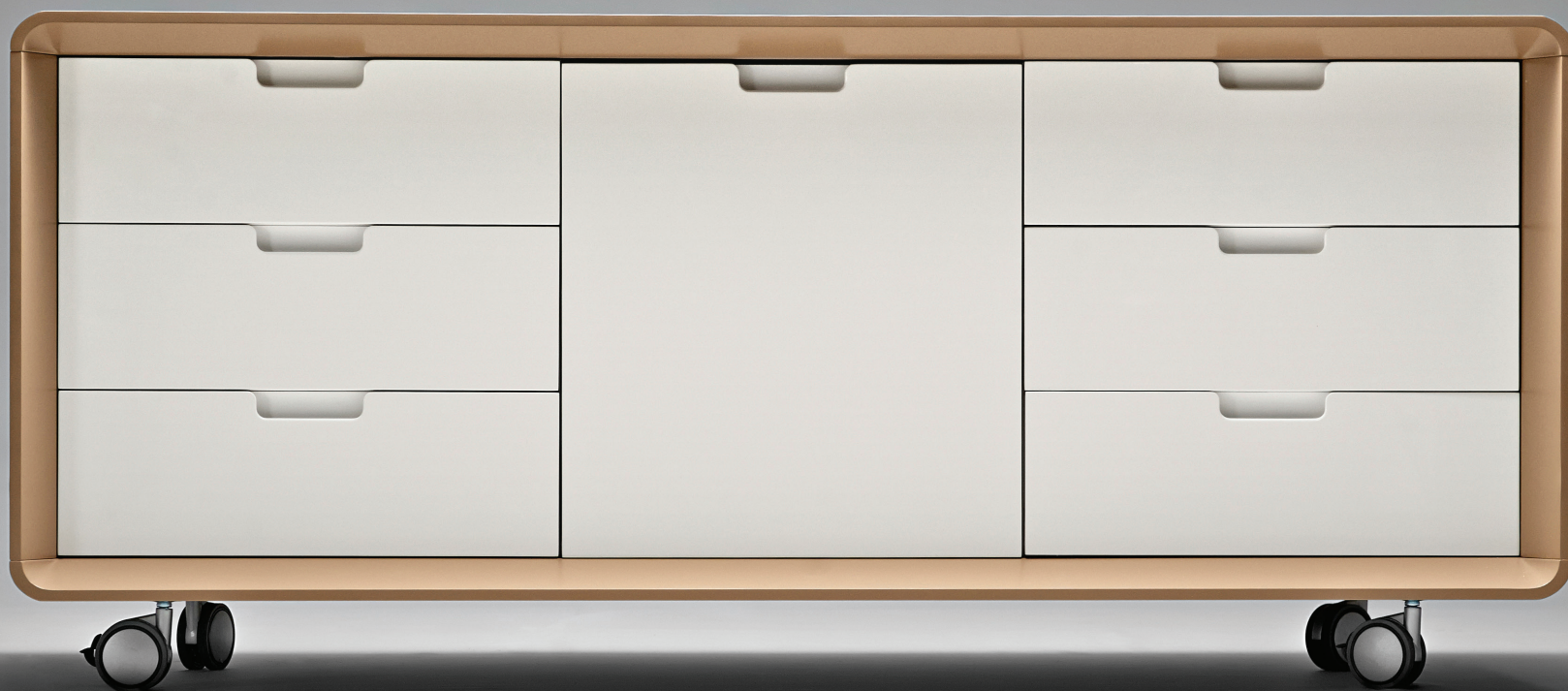

◆ colored lacquer



◆ teak wood veneer and colored lacquer

2015







◆ teak wood veneer and colored lacquer









Executive desk new

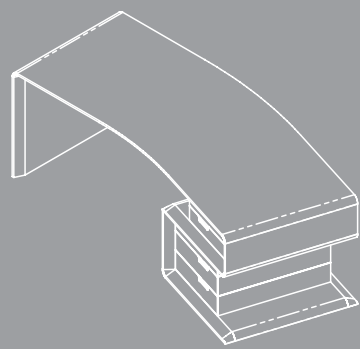

|            |                 |
|------------|-----------------|
| APSK.11.20 | 2000x1160x750   |
| APSK.11.22 | 2200x1160x750   |
| finishing  | Colored lacquer |

Negotiations table

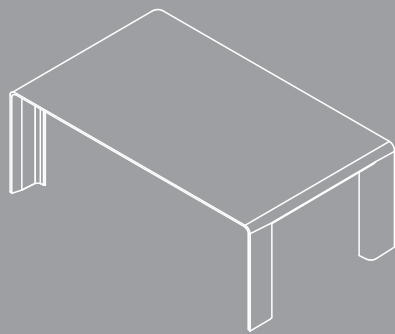

|            |                         |
|------------|-------------------------|
| APSK.12.20 | 2000x1200x750           |
| APSK.12.24 | 2400x1200x750           |
| APSK.12.28 | 2800x1200x750           |
| finishing  | Veneer, colored lacquer |

Cabinet

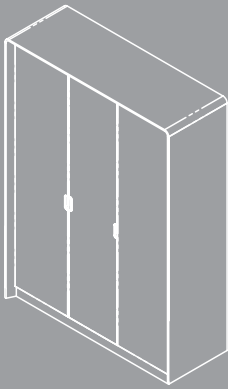

|           |                                    |
|-----------|------------------------------------|
| APSK.31   | 1780x350x2110                      |
| finishing | Veneer, colored lacquer, plexiglas |

Wall-mounted shelf

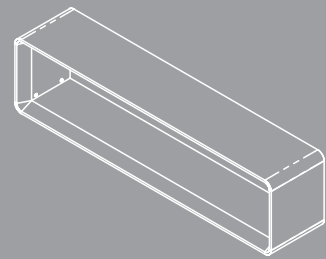

|           |                         |
|-----------|-------------------------|
| APSK.40   | 1600x400x330            |
| finishing | Veneer, colored lacquer |

Rolling file cabinet

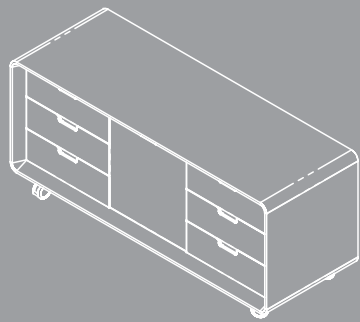

|           |                         |
|-----------|-------------------------|
| APSK.20.2 | 1600x570x697            |
| finishing | Veneer, colored lacquer |

File cabinet

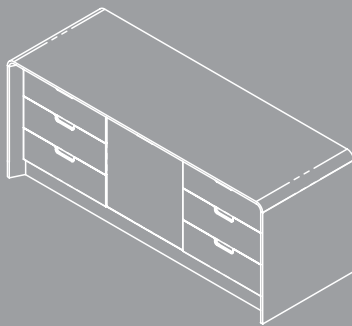

|           |                         |
|-----------|-------------------------|
| APSK.20.1 | 1600x570x697            |
| finishing | Veneer, colored lacquer |



Meeting console

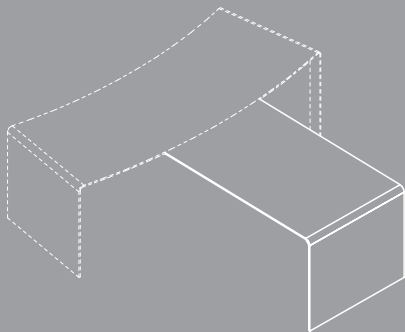

APSK.50.14 **1400x100x750**  
finishing **Veneer, colored lacquer**

Executive desk

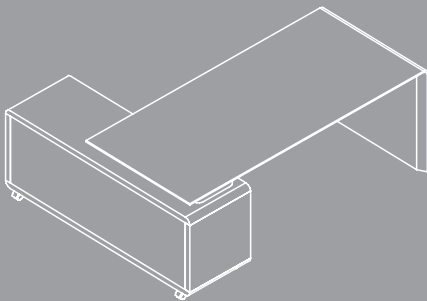

APSK.13.20 **2000x1000x750**  
APSK.13.22 **2200x1000x750**  
finishing **Veneer, colored lacquer**

Coffee table

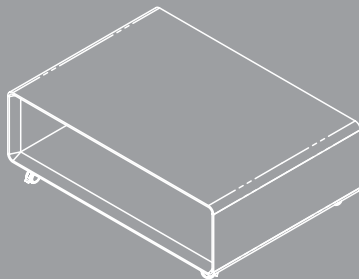

APSK.24 **1000x900x450**  
finishing **Veneer, colored lacquer**

Small rolling file cabinet

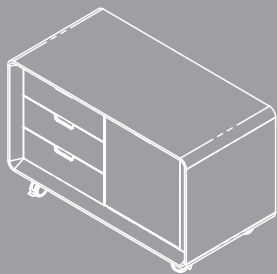

APSK.10 **800x570x697**  
finishing **Veneer, colored lacquer**